

# REGIONAL TRANSPORTATION COMMISSION

## MEETING AGENDA

DATE: February 20, 2020

TIME: 8:00 a.m.

PLACE: WHITE PINE COUNTY LIBRARY  
950 CAMPTON STREET, ELY, NEVADA

### NEW BUSINESS:

1. Opening Activities –  
Meeting called to order  
Roll Call
2. Comments from the Public (3 minute time limit)
3. Discussion for Possible Action - Selection of RTC Chairman position
4. Discussion – Current NDOT projects
5. Discussion – Current City of Ely Projects
6. Discussion – Current County Projects
7. Discussion for Possible Action – Public Transit Budget FY21
8. Discussion for Possible Action – RTC Budget FY21
9. Discussion for Possible Action – How to proceed with requests for hard copies and agendas
10. Discussion – Set Date for Next RTC Meeting
11. Approval of RTC Meeting Minutes (November 21, 2019)
12. Comments from the Public (3 minute time limit)

\*Open Session

\*The meeting may be closed by an appropriate motion for the purpose of discussing any matter allowed under N.R.S. 241.030(1) to consider the character, alleged misconduct, professional competence of physical or mental health of a person/employee. Items on the agenda may be taken out of order. The Public Body may combine two or more agenda items for consideration. The Public Body may remove an item from the agenda or delay discussion at any time.

### NOTICE TO PERSONS WITH DISABILITIES:

Members of the public who are disabled and require special assistance or accommodations at the meeting are requested to notify the Board of County Commissioners, White Pine County Clerk at 801 Clark Street, Ely, Nevada 89301 or by calling (775) 293-6509 at least one (1) day in advance. TDD Relay Service \*800-444-7861

### AFFIDAVIT

I, Naomi Harris, did on February 13, 2020, between the hours of 8:00 a.m. and 5:00 p.m., post five (5) notices of the Regional Transportation Commission Agenda in the County of White Pine, to wit; at the front door of the Courthouse, WPC Administration Bldg., County Library, Ely Main Post Office, WPC Aquatics Center and e-mailed to the WPC Clerk. The meeting notice is also posted at the White Pine County website at <http://whitepinecounty.net> and on the State of Nevada Public Notices website at <http://notice.nv.gov>. An additional copy of the Agendas along with supporting material, if any, are on display and available at the front counter of the White Pine County Clerk's Office at 801 Clark Street, Suite 4, Ely, NV 89301.

---

Naomi Harris, RTC Recording Secretary



## Public Transit Budget FY2021

**County Road Expenditures (#063-451-52513):**

**Road Oils:**

QSE Oil Stabilization.....	\$ 15,000.00
QSE Fog Seal Oil.....	18,000.00
PMRE-H Chip Oil.....	6,000.00
LMCR-S Chip Oil.....	71,000.00
QSRE Rejuvenation Oil.....	46,000.00
CRS-2 Durapatch Oil.....	8,000.00
Magnesium Chloride.....	154,000.00
Salt Sand.....	11,000.00

**Total County Road Expenditures: \$ 329,000.00**

**Equipment Over \$5,000 (#063-451-53101):**

3/4 ton Crew truck.....	\$ 33,100.00
140M Grader/5 year buy back option.....	337,000.00
Cab and Chassis for water tank mount.....	145,000.00
(2) Used Transport Trucks.....	200,000.00
Generator & Trailer /Long Valley Well.....	7,500.00

**Total Equipment Over \$5,000: \$ 722,600.00**

### Summary Public Transit Budget FY2021

Equipment Under \$5,000	\$ 4,500.00
Ely Bus Expenses	27,000.00
City Road Expenditures	<u>          </u>
County Road Expenditures	329,000.00
Equipment over \$5,000	722,600.00
<b>Total RTC Budget Request:</b>	<b>\$ <u>1,083,100.00</u></b>



White Pine County, NV

# Budget Worksheet

## Account Summary

For Fiscal: 2019-2020 Period Ending: 06/30/2020

	2017-2018 Total Budget	2017-2018 Total Activity	2018-2019 Total Budget	2018-2019 Total Activity	2019-2020 Total Budget	2019-2020 YTD Activity	Defined Budgets 2020-2021 DEPART REQUESTS
<b>Fund: 063 - PUBLIC TRANSIT</b>							
<b>Revenue</b>							
SALES TAX	600,000.00	716,746.51	600,000.00	779,157.49	600,000.00	341,004.36	600,000.00
INTEREST	1,500.00	35,292.60	25,000.00	39,654.68	25,000.00	0.00	25,000.00
<b>Revenue Total:</b>	<b>601,500.00</b>	<b>752,039.11</b>	<b>625,000.00</b>	<b>818,812.17</b>	<b>625,000.00</b>	<b>341,004.36</b>	<b>625,000.00</b>
<b>Expense</b>							
EQUIPMENT UNDER \$5000	5,000.00	0.00	5,000.00	1,097.00	0.00	0.00	4,500.00
<b>Subject</b>	<b>Description</b>						
SUPPLIES	SIGNAGE AND SAFETY ITEMS						
ELY BUSS EXPENSES	25,000.00	16,467.98	27,000.00	19,152.84	57,000.00	6,369.41	27,000.00
<b>Subject</b>	<b>Description</b>						
ELY BUS EXPENSES	AMOUNT APPROVED BY DESI BARNSON						
CITY ROAD EXPENDITURE	168,200.00	151,362.99	163,779.00	113,328.92	219,248.00	64,312.41	
<b>Subject</b>	<b>Description</b>						
CITY OF ELY - PENDING	PENDING RTC MEETING 02.20.2020						
COUNTY ROAD EXPENDITURES	244,000.00	113,207.49	220,000.00	93,484.81	225,000.00	6,777.57	329,000.00
<b>Subject</b>	<b>Description</b>						
COUNTY ROAD EXPENDITURES	QSE OIL \$15,000						
	QSE FOGSEAL \$18,000						
	PMRE CHIP OIL \$6,000						
	LMCR OIL \$71,000						
	QSRRE REJUVINATING OIL \$46,000						
	CRS-2 DURAPATCH OIL \$8,000						
	MAG-CHLORIDE \$154,000						
	SALT SAND \$11,000						
EQUIPMENT OVER \$5000	618,610.00	531,400.00	511,500.00	458,126.40	593,500.00	173,742.58	722,600.00

Budget Worksheet

For Fiscal: 2019-2020 Period Ending: 06/30/2020

Defined Budgets

	2017-2018	2017-2018	2018-2019	2018-2019	2019-2020	2019-2020	2020-2021
	Total Budget	Total Activity	Total Budget	Total Activity	Total Budget	YTD Activity	DEPART REQUESTS

Budget Notes

Budget Code  
DEPART REQUESTS  
DEPART REQUESTS  
DEPART REQUESTS  
DEPART REQUESTS

Subject

(2) USED TRANSPORT TRUCKS  
140M GRADER W/ BUY-BACK OPTION

Description

EQUIPMENT MATERIAL AND SNOW HAULING \$200,000  
140M GRADER W/ BUY-BACK OPTION \$337,000

DEPART REQUESTS

DEPART REQUESTS

DEPART REQUESTS

3/4 TON CREW TRUCK

CAB AND CHASSIS

GENERATOR & TRAILER

EXERCISING BUY-BACK OPTION FOR GRADER GR-15 IN THE AMOUNT OF [\$267,000]

3/4 TON CREW TRUCK \$33,100

ROAD DEPT OWNS (1) WATER TANK; WILL MOUNT ON CHASSIS \$145,000

GENERATOR & TRAILER - LONG VALLEY WELL \$7,500

Budget Detail

Budget Code

DEPART REQUESTS

DEPART REQUESTS

DEPART REQUESTS

DEPART REQUESTS

DEPART REQUESTS

DEPART REQUESTS

Description

(2) USED TRANSPORT TRUCKS

140M GRADER W/ BUY-BACK OPTION

3/4 TON CREW TRUCK

CAB AND CHASSIS

GENERATOR & TRAILER - LONG VALLEY WEI

Units

2.00

1.00

1.00

1.00

1.00

Price

100,000.00

337,000.00

33,100.00

145,000.00

7,500.00

Amount

200,000.00

337,000.00

33,100.00

145,000.00

7,500.00

Expense Total:

1,060,810.00

812,438.46

927,279.00

685,189.97

1,094,748.00

251,201.97

1,083,100.00

Fund: 063 - PUBLIC TRANSIT Surplus (Deficit):

-459,310.00

-60,399.35

-302,279.00

133,622.20

-469,748.00

89,802.39

-458,100.00

Report Surplus (Deficit):

-459,310.00

-60,399.35

-302,279.00

133,622.20

-469,748.00

89,802.39

-458,100.00

**WHITE PINE COUNTY**  
**PUBLIC TRANSIT FUND**  
**FUND 063**

Year	Actual	City (29%)	County (71%)		
<b>2009</b>	Through 6/30/2009				
Revenue	\$ 606,652	\$ 175,929	\$ 430,723	Total Exp	
Ely Buss Expenditures	\$ (15,683)	\$ (4,548)	\$ (11,135)	Total Exp	\$ (543,364)
Expenditures	\$ (527,681)	\$ (158,799)	\$ (368,882)	Total FB	
End Fund Balance	\$ 1,201,910	\$ 249,856	\$ 952,054	Total FB	\$ 1,201,910
<b>2010</b>	Through 6/30/2010				
Revenue	\$ 432,498	\$ 125,424	\$ 307,073	Total Exp	
Ely Buss Expenditures	\$ (15,886)	\$ (4,607)	\$ (11,279)	Total Exp	\$ (520,292)
Expenditures	\$ (504,406)	\$ (186,815)	\$ (317,590)	Total FB	
End Fund Balance	\$ 1,114,115	\$ 183,858	\$ 930,257	Total FB	\$ 1,114,115
<b>2011</b>	Through 6/30/11				
Revenue	\$ 775,084	\$ 224,774	\$ 550,309	Total Exp	
Ely Buss Expenditures	\$ (17,248)	\$ (5,002)	\$ (12,246)	Total Exp	\$ (260,375)
Expenditures	\$ (243,127)	\$ (50,919)	\$ (192,208)	Total FB	
End Fund Balance	\$ 1,628,824	\$ 352,711	\$ 1,276,113	Total FB	\$ 1,628,824
<b>2012</b>	Through 6/30/12				
Revenue	\$ 744,810	\$ 215,995	\$ 528,815	Total Exp	
Ely Buss Expenditures	\$ (16,000)	\$ (4,640)	\$ (11,360)	Total Exp	\$ (760,483)
Expenditures	\$ (744,483)	\$ (279,790)	\$ (464,694)	Total FB	
End Fund Balance	\$ 1,613,150	\$ 284,276	\$ 1,328,874	Total FB	\$ 1,613,150
<b>2013</b>	Through 6/30/13				
Revenue	\$ 659,432	\$ 191,235	\$ 468,197	Total Exp	
Ely Buss Expenditures	\$ (19,045)	\$ (5,523)	\$ (13,522)	Total Exp	\$ (454,416)
Expenditures	\$ (435,371)	\$ (110,708)	\$ (324,663)	Total FB	
End Fund Balance	\$ 1,818,166	\$ 359,281	\$ 1,458,885	Total FB	\$ 1,818,166
<b>2014*</b>	Through 6/30/2014				
Revenue	\$ 611,138	\$ 177,230	\$ 433,908	Total Exp	
Ely Buss Expenditures	\$ (20,990)	\$ (6,087)	\$ (14,903)	Total Exp	\$ (406,326)
Expenditures	\$ (385,335)	\$ (155,567)	\$ (229,768)	Total FB	
End Fund Balance	\$ 2,022,978	\$ 374,856	\$ 1,648,121	Total FB	\$ 2,022,978
<b>2015</b>	Through 6/30/2015				
Revenue	\$ 668,166	\$ 193,768	\$ 474,398	Total Exp	
Ely Buss Expenditures	\$ (18,329)	\$ (5,315)	\$ (13,013)	Total Exp	\$ (395,981)
Expenditures	\$ (377,652)	\$ (36,996)	\$ (340,656)	Total FB	
End Fund Balance	\$ 2,295,163	\$ 526,313	\$ 1,768,849	Total FB	\$ 2,295,163
		<b>City(16.397%)</b>	<b>County(83.603%)</b>	<b>Starting FY2016 per B. Miller</b>	
		<b>City(27%)</b>	<b>County(73%)</b>	<b>9/25/2017 Retro back to 7/1/2015 per RTC Board</b>	
<b>2016</b>	Through 6/30/2016				
Revenue	\$ 559,920	\$ 151,178	\$ 408,741	Total Exp	
Ely Buss Expenditures	\$ (12,988)	\$ (3,507)	\$ (9,481)	Total Exp	\$ (627,996)
Expenditures	\$ (615,008)	\$ (147,235)	\$ (467,773)	Total FB	
End Fund Balance	\$ 2,227,087	\$ 526,750	\$ 1,700,337	Total FB	\$ 2,227,087
<b>2017</b>	Through 6/30/2017				
Revenue	\$ 619,079	\$ 167,151	\$ 451,928	Total Exp	
Ely Buss Expenditures	\$ (12,461)	\$ (3,364)	\$ (9,096)	Total Exp	\$ (763,616)
Expenditures	\$ (751,156)	\$ (456,091)	\$ (295,064)	Total FB	
End Fund Balance	\$ 2,082,550	\$ 234,446	\$ 1,848,104	Total FB	\$ 2,082,550
<b>2018</b>	Through 06/30/2018				
Revenue	\$ 752,039	\$ 203,051	\$ 548,989	Total Exp	
Ely Buss Expenditures	\$ (16,468)	\$ (4,446)	\$ (12,022)	Total Exp	\$ (812,438)
Expenditures	\$ (795,970)	\$ (151,363)	\$ (644,607)	Total FB	
End Fund Balance	\$ 2,022,151	\$ 281,687	\$ 1,740,463	Total FB	\$ 2,022,151
<b>2019</b>	Through 06/30/2019				
Revenue	\$ 818,812	\$ 221,079	\$ 597,733	Total Exp	
Ely Buss Expenditures	\$ (19,153)	\$ (5,171)	\$ (13,982)	Total Exp	\$ (685,190)
Expenditures	\$ (666,037)	\$ (113,329)	\$ (552,708)	Total FB	
End Fund Balance	\$ 2,155,773	\$ 384,266	\$ 1,771,506	Total FB	\$ 2,155,773
		<b>CITY (29.3%)</b>	<b>COUNTY (70.7%)</b>		
<b>2020*</b>	Through 01/31/2020				
Revenue	\$ 275,905	\$ 80,840	\$ 195,065	Total Exp	
Ely Buss Expenditures	\$ (6,369)	\$ (1,866)	\$ (4,503)	Total Exp	\$ (217,514)
Expenditures	\$ (211,145)	\$ (64,312)	\$ (146,833)	Total FB	
End Fund Balance	\$ 2,214,164	\$ 398,928	\$ 1,815,236	Total FB	\$ 2,214,164

\*Fiscal year 2020 is unaudited and subject to adjustment pending audit.

**County RTC Budget  
FY2021**

**County Road Expenditures (#065-451-52513):**

Crack Seal (Split semi load w/ City of Ely)..... \$ 10,000.00

**Total County Road Expenditures: \$ 10,000.00**

**Contract Projects (Contract Services #060-451-52915):**

Ruth Slurry/Micro seal (County).....\$ 360,000.00

o **RTC Joint Equipment Rental (50/50 split)**

• Compaction Rollers @ \$6,720.00 per month (4 Months \* 2)..... \$53,760.00

• Kick Broom.....5,000.00

Equipment Rental (\$ 29,380 County / \$29,380 City)..... 29,380.00

**Total Contract Services Budget Request: \$ 389,380.00**

**Total County RTC Budget Request: \$ 399,380.00**

**City RTC Budget  
FY2021**

**City Road Expenditures (#065-451-52512):**

**Materials**

QSE Oil Stabilization and Fog Seal 10 Tons @ \$420.00.....	\$ 4,200.00
1/2" Chip oil PMRE-H (4) Tons @ \$630.00.....	2,600.00
3/8" Chip oil LMCR-S (3) tons @ \$555.00.....	1,700.00
Dura-patch oil (25) tons @ \$550.00.....	14,000.00
Tack oil MC-800 (4) tons @ \$1,022.00.....	4,100.00
3/8" Chips (100) Tons @ \$30.00.....	3,000.00
Salt/Sand.....	13,000.00
Cold mix asphalt (400) Tons @ \$115.00.....	46,000.00
Crack Seal (Split semi load w/ County).....	10,000.00

**Total Road Materials:** **\$ 98,600.00**

**Contract Projects**

Type 2 Slurry (122,000 SY's) @ \$2.50.....	\$ 305,000.00
Valley cutters, curb, gutters, sidewalks, DI boxes.....	50,000.00

**Total Contract Projects:** **\$ 355,000.00**

**Total City Road Expenditures:** **\$ 453,600.00**

**Contract Services (#060-451-52915):**

- **RTC Joint Equipment Rental (50/50 split)**
  - **Compaction Rollers @ \$6,720.00 per month (4 Months \* 2).....** \$53,760.00
  - **Kick Broom.....** 5,000.00

Equipment Rental (\$ 29,380 County / \$29,380 City)..... 29,380.00

**Total Contract Services:** **\$ 29,380.00**

**Total City RTC Budget Request** **\$ 482,980.00**



## County/City Joint RTC Budget FY2021

### Contract Projects (Contract Services #060-451-52915):

○ RTC Joint Equipment Rental (50/50 split)	
• Compaction Rollers @ \$6,720.00 per month (4 Months * 2).....	\$53,760.00
• Kick Broom.....	5,000.00
Equipment Rental (\$ 29,380 County / \$29,380 City).....	\$ 58,760.00

**Total Joint Contract Services Budget Request: \$ 58,760.00**

### Joint Equipment Purchase (Equip over \$5,000 #065-451-53101):

One Ton Truck with dump flatbed	\$ 57,000.00
1,000 gallon heated storage and transport trailer for tack oil	40,000.00
140 M Grader (WPC owned)	82,000.00
Mechanical Sweeper	320,000.00

**Total Joint Equipment Purchase: \$ 499,000.00**

**Total Joint County/City Budget Request: \$ 557,760.00**

## Summary RTC Budget FY2021

PACT	\$ 250.00
Legal Advertising	500.00
Postage	300.00
Equipment under \$5,000	4,000.00
Equipment fuel	5,000.00
Oil & grease	500.00
Equipment repair & maintenance	7,000.00
City Road Expenditures	453,600.00
County Road Expenditures	10,000.00
County Contract Services (Ruth Slurry)	360,000.00
Engineering	40,000.00
Joint Contract Services	58,760.00
Joint Equipment Purchase	499,000.00
<b>Total RTC Budget Request:</b>	<b>\$ <u>1,438,910.00</u></b>

# Budget Worksheet

## Account Summary

For Fiscal: 2019-2020 Period Ending: 06/30/2020

White Pine County, NV

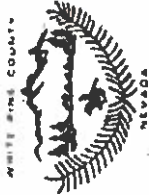

	2017-2018 Total Budget	2017-2018 Total Activity	2018-2019 Total Budget	2018-2019 Total Activity	2019-2020 Total Budget	2019-2020 YTD Activity	Defined Budgets
							2020-2021 DEPART REQUESTS
1 TO 9 CENTS GAS TAX OPT	647,054.00	671,795.57	664,821.00	680,874.03	688,966.00	319,040.94	688,966.00
INTEREST	1,500.00	26,206.15	18,000.00	45,819.26	18,000.00	0.00	18,000.00
<b>Revenue Total:</b>	<b>648,554.00</b>	<b>698,001.72</b>	<b>682,821.00</b>	<b>726,693.29</b>	<b>706,966.00</b>	<b>319,040.94</b>	<b>706,966.00</b>
<b>Expense</b>							
PACT	450.00	380.48	450.00	380.48	250.00	0.00	250.00
LEGAL ADVERTISING	500.00	0.00	500.00	132.00	500.00	146.00	500.00
POSTAGE	300.00	0.00	300.00	59.59	300.00	0.00	300.00
EQUIPMENT UNDER \$5000	4,000.00	0.00	4,000.00	0.00	4,000.00	1,029.18	4,000.00
EQUIPMENT FUEL	0.00	0.00	3,000.00	0.00	3,000.00	1,101.43	5,000.00
<b>Subject</b>	<b>Description</b>						
ADDITIONAL FUEL	FUEL CONSUMED BY (NEW) MECHANICAL SWEEPER						
OIL AND GREASE	0.00	0.00	500.00	0.00	500.00	0.00	500.00
EQUIPMENT REPAIR & MAINT	0.00	0.00	5,000.00	19.45	5,000.00	2,656.99	7,000.00
<b>Subject</b>	<b>Description</b>						
MECHANICAL SWEEPER	ADDITIONAL CURB BROOMS (WEAR ITEM)						
CITY ROAD EXPENDITURE	0.00	0.00	250,000.00	44,498.80	200,000.00	42,486.78	453,600.00
<b>Subject</b>	<b>Description</b>						
CITY OF ELY BUDGET REQUEST BREAKDOWN	ROAD MATERIALS \$98,600						
	SLURRY CONTRACT PRICE ESTIMATE \$305,000						
	VALLEY GUTTER/DI BOXES/CURB & GUTTER \$50,000						
COUNTY ROAD EXPENDITURES	0.00	0.00	250,000.00	84,152.88	480,000.00	191,674.70	10,000.00

### Fund: 065 - REGIONAL TRANSPORTATION

Revenue

065-000-31514-000  
065-000-36303-000

Expense

065-451-52503-000  
065-451-52506-000  
065-451-52102-000  
065-451-52133-000  
065-451-52503-000

Budget Notes

Budget Code  
DEPART REQUESTS

065-451-52504-000  
065-451-52505-000

Budget Notes

Budget Code  
DEPART REQUESTS

065-451-52512-000

Budget Notes

Budget Code  
DEPART REQUESTS

065-451-52513-000

Budget Worksheet

For Fiscal: 2019-2020 Period Ending: 06/30/2020

		2017-2018					2018-2019		2019-2020		Defined Budgets	
		Total Budget	Total Activity	Total Budget	Total Activity	Total Budget	Total Activity	2019-2020	YTD Activity	2020-2021	DEPART REQUESTS	
<b>Budget Notes</b>												
<b>Budget Code</b>												
DEPART REQUESTS	COUNTY BUDGET REQUEST BREAKDOWN											
	Description											
	ROAD MATERIALS \$10,000											
	CRACKSEAL (SPLIT SEMI LOAD W/ CITY OF ELY)											
065-451-52911-000	ENGINEERING	64,860.00	26,830.00	40,000.00	130.00	40,000.00	0.00	0.00	0.00	40,000.00		
065-451-52915-000	CONTRACT SERVICES	0.00	0.00	84,800.00	0.00	290,000.00	26,574.00	418,760.00				
<b>Budget Notes</b>												
<b>Budget Code</b>												
DEPART REQUESTS	COUNTY BUDGET REQUEST BREAKDOWN											
	Description											
	RUTH SLURRY CONTRACT COST ESTIMATE \$360,000											
	TOTAL EQUIPMENT RENTAL \$58,760											
	- EQUIPMENT RENTAL 50% COUNTY \$29,380 / 50% CITY \$29,380											
065-451-53101-000	EQUIPMENT OVER \$5000	33,425.00	33,425.00	240,000.00	238,712.50	0.00	0.00	499,000.00				
<b>Budget Notes</b>												
<b>Budget Code</b>												
DEPART REQUESTS	COUNTY BUDGET REQUEST BREAKDOWN											
	Description											
	1 TON FLAT BED											
	1,000 GALLON HEATED STORAGE TANK											
	140M GRADER											
	MECHANICAL SWEEPER											
	WPC PURCHASED GRADER THROUGH PUBLIC TRANSIT FUNDS; RETURN FUNDS TO WPC PUBLIC TRANSIT											
	MECHANICAL SWEEPER											
<b>Budget Detail</b>												
<b>Budget Code</b>												
DEPART REQUESTS	Description	Units	Price	Amount								
DEPART REQUESTS	1 TON FLAT BED	1.00	57,000.00	57,000.00								
DEPART REQUESTS	140M GRADER	1.00	82,000.00	82,000.00								
DEPART REQUESTS	MECHANICAL SWEEPER	1.00	320,000.00	320,000.00								
DEPART REQUESTS	TRANSPORT TRAILER FOR TACK OIL	1.00	40,000.00	40,000.00								
065-451-53160-000	CAPITAL IMPROVEMENTS	1,105,965.00	781,273.44	0.00	0.00	70,000.00	0.00	0.00	0.00	1,438,910.00		
	Expense Total:	1,209,500.00	841,908.92	878,550.00	368,085.70	1,093,550.00	265,669.08	1,438,910.00				
	Fund: 065 - REGIONAL TRANSPORTATION Surplus (Deficit):	-560,946.00	-143,907.20	-195,729.00	358,607.59	-386,584.00	53,371.86	-731,944.00				
	Report Surplus (Deficit):	-560,946.00	-143,907.20	-195,729.00	358,607.59	-386,584.00	53,371.86	-731,944.00				

**WHITE PINE COUNTY**

**RTC FUND  
FUND 065**

Year	Actual
<b>2006</b>	
Fund Balance	\$ 738,013
<b>2007</b>	
Revenue	\$ 621,149
Expenditures	\$ (510,879)
End Fund Balance	\$ 848,283
<b>2008</b>	
Revenue	\$ 655,622
Expenditures	\$ (538,910)
End Fund Balance	\$ 964,995
<b>2009</b>	
Revenue	\$ 575,269
Expenditures	\$ (484,101)
End Fund Balance	\$ 1,056,164
<b>2010</b>	
Revenue	\$ 591,894
Expenditures	\$ (638,960)
End Fund Balance	\$ 1,009,098
<b>2011</b>	
Revenue	\$ 613,920
Expenditures	\$ (568,828)
End Fund Balance	\$ 1,054,190
<b>2012</b>	
Revenue	\$ 643,537
Expenditures	\$ (606,395)
End Fund Balance	\$ 1,091,332
<b>2013</b>	
Revenue	\$ 627,496
Expenditures	\$ (288,650)
End Fund Balance	\$ 1,430,178
<b>2014</b>	
Revenue	\$ 627,415
Expenditures	\$ (797,581)
End Fund Balance	\$ 1,260,012
<b>2015</b>	Through 6/30/2015
Revenue	\$ 652,050
Expenditures	\$ (319,813)
End Fund Balance	\$ 1,592,249
<b>2016</b>	Through 6/30/2016
Revenue	\$ 655,746
Expenditures	\$ (161,923)
End Fund Balance	\$ 2,086,072
<b>2017</b>	Through 6/30/2017
Revenue	\$ 659,179
Expenditures	\$ (679,168)
End Fund Balance	\$ 2,066,083
<b>2018</b>	Through 6/30/2018
Revenue	\$ 698,002
Expenditures	\$ (841,909)
End Fund Balance	\$ 1,922,175
<b>2019</b>	Through 06/30/2019
Revenue	\$ 726,693
Expenditures	\$ (368,086)
End Fund Balance	\$ 2,280,783
<b>*2020</b>	Through 01/31/2020
Revenue	\$ 319,041
Expenditures	\$ (253,398)
End Fund Balance	\$ 2,346,426

\* Fiscal year 2020 is unaudited and subject to adjustment pending audit.



Consulting Engineers & Land Surveyors

WHITE PINE COUNTY - RTC  
 MURRY STREET PAVING PROJECT 2020  
 ENGINEERING ESTIMATE

February 11, 2020

BIDDING SCHEDULE	UNIT	PAVING ENGINEERING ESTIMATE			SEWER PROJECT ESTIMATE		
		AMOUNT	UNIT PRICE	BID AMOUNT	AMOUNT	UNIT PRICE	BID AMOUNT
1 MOBILIZATION / DEMOBILIZATION	LS	1	\$ 20,900.00	\$ 20,900.00			\$ -
2 REMOVAL OF EXISTING SIDEWALK	SF	6,275	\$ 2.10	\$ 13,177.50	540	\$ 2.10	\$ 1,134.00
3 REMOVAL OF EXISTING CURB AND GUTTER	SF	1,255	\$ 4.00	\$ 5,020.00	216	\$ 4.00	\$ 864.00
4 REMOVAL OF EXISTING VALLEY GUTTER	LF	495	\$ 4.00	\$ 1,980.00		\$ 4.00	\$ -
5 REMOVAL OF EXISTING ASPHALT PAVEMENT	SF	23,180	\$ 2.50	\$ 57,950.00	6,160	\$ 2.50	\$ 15,400.00
6 REMOVAL OF OVER EXCAVATED MATERIAL	SF	23,180	\$ 3.50	\$ 81,130.00	6,160	\$ 3.50	\$ 21,560.00
7 TYPE-I CONCRETE CURB	LF	1,255	\$ 40.00	\$ 50,200.00	216	\$ 40.00	\$ 8,640.00
8 CONCRETE VALLEY GUTTER	SF	495	\$ 20.00	\$ 9,900.00		\$ 20.00	\$ -
9 CONCRETE SIDEWALK	SF	6,275	\$ 12.00	\$ 75,300.00	540	\$ 12.00	\$ 6,480.00
10 ASPHALT PAVEMENT	SF	23,180	\$ 2.50	\$ 57,950.00	6,160	\$ 2.50	\$ 15,400.00
11 TYPE-II BASE	CY	600	\$ 40.00	\$ 24,000.00	132	\$ 40.00	\$ 5,280.00
12 PIT RUN SUBBASE	SF	23,180	\$ 0.85	\$ 19,703.00	6,160	\$ 0.85	\$ 5,236.00
13 GEOTEXTILE FABRIC	SF	23,180	\$ 0.50	\$ 11,590.00	6,160	\$ 0.50	\$ 3,080.00
14 ADJUST MANHOLE/WATER VALVE COVERS	EA	8	\$ 1,200.00	\$ 9,600.00	8	\$ 1,200.00	\$ 9,600.00
15 ENGINEERING/CONSTRUCTION MANAGEMENT	LS	1	\$ 65,700.00	\$ 65,700.00			\$ -
<b>TOTAL ESTIMATE PRICE</b>				<b>\$ 504,100.50</b>			<b>\$ 92,674.00</b>

- ESTIMATED 19 SEWER SERVICE CONNECTIONS
- ESTIMATED 8 WATER SERVICE CONNECTIONS
- BOTH SEWER/WATER TRENCH WIDTH ESTIMATED AT 4'
- WATER LATERAL, SEWER LATERAL, & SEWER MAIN ESTIMATED TRENCH LENGTH AT 1,540 LF

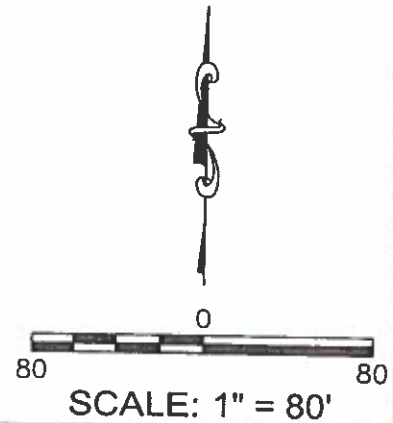
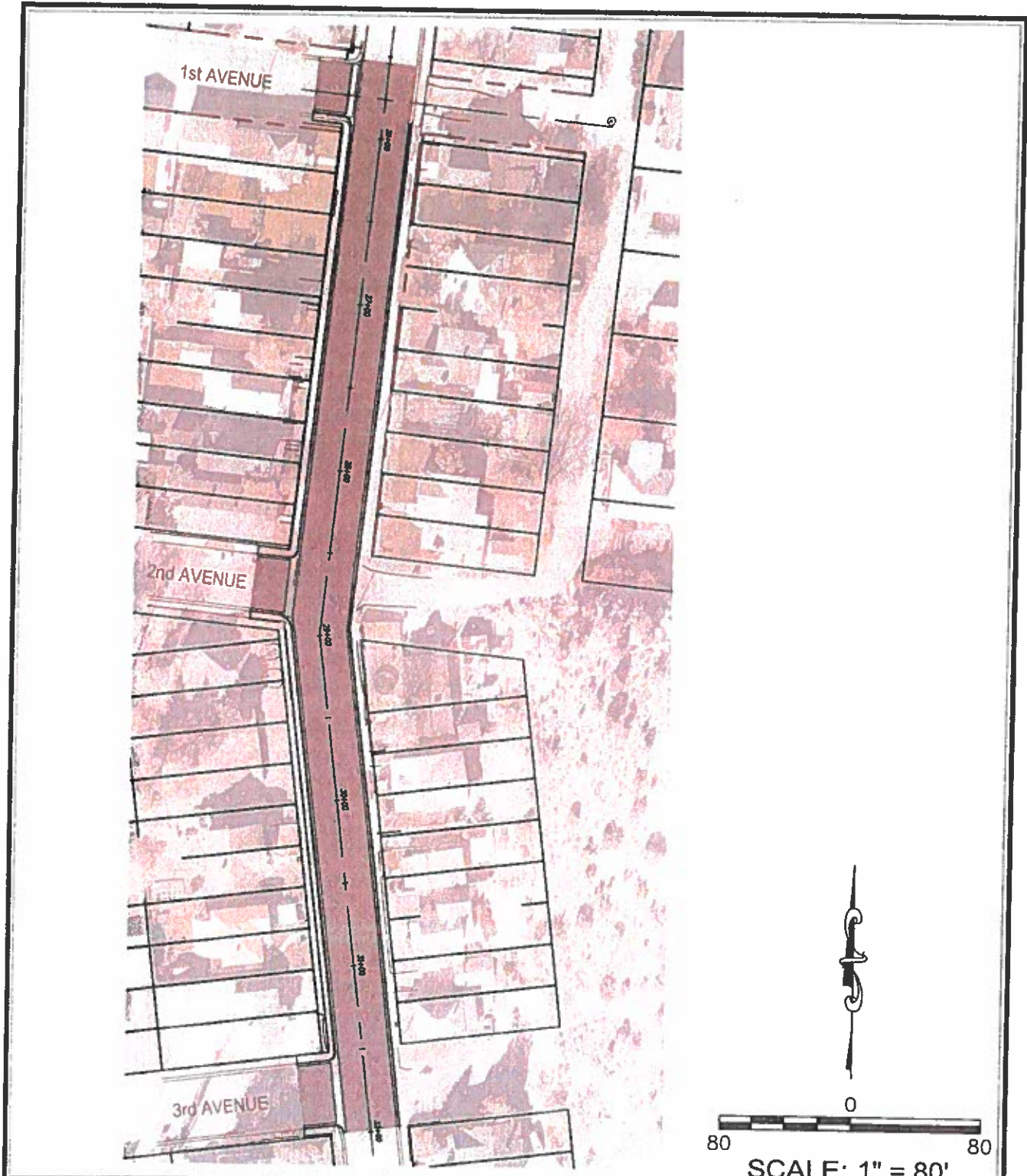

**MURRY STREET  
PROPOSED RECONSTRUCTION**

DATE 2/5/2020  
 JOB NO. 1208057  
 SCALE 1" = 80'

**Basin Engineering**  
 Consulting Engineers & Land Surveyors  
 1070 E. Fullman Street, Elko, NV 89501  
 Phone: (775) 289-9800 Fax: (775) 289-9802

Nichole Baldwin  
County Clerk

Leia Wells  
Chief Deputy Clerk

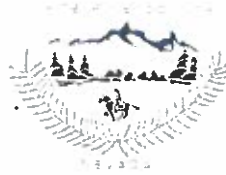

Susan Lujan  
Deputy Clerk

Melissa Tremain  
Deputy Clerk

## WHITE PINE COUNTY CLERK

January 8, 2020

White Pine County Advisory Boards and Town Councils

Dear Honorable Chairmen and Chairwomen, Secretaries, and Members:

During today's regular County Commission Meeting, the Board of County Commissioners discussed the possibility of voting to approve to cease mailing out hard copies of agendas, packets, and approved meeting minutes to Board Members, Commission Liaisons, and requesting parties automatically. Instead, it was suggested that the material be made available online pursuant to the Open Meeting Law. An individual who cannot obtain the information from online will be able to make a written request to the Board for hard copies. It will be up to the Board if they will allow the requests to expire and how often people will need to make such requests. This item was brought to the Commission by Commissioner Travis Godon in an effort to reduce material and postage costs. This action was approved and this letter is notifying you of such.

From this point forward, please contact the individuals who normally receive hard copies of agendas, meeting packets, and approved meeting minutes from your Board and notify them of this change. Encourage them to obtain these documents online at [whitepinecounty.net](http://whitepinecounty.net). Also, give them the opportunity to make a written request for hard copies and determine within your Board how often you will require these requests and if they will expire.

Putting all of your backup material online with your agenda is easy! Simply scan the items in individually/separately and name the files to clearly tie them to the agenda item and save as PDF files. Email those files to me and Susan Lujan with a Word document of your agenda and we will be able to link the items on our side and post the agenda on the County and State websites like we have been. If you have a scanner, it's not much extra work if you were already making copies. In fact, it might save you more time.

Open Meeting Law does require that all backup material for a meeting of a public body be provided in advance of the meeting to the public if and when it becomes available. This change will mean even more public access to your board and better transparency if you aren't already doing this. If you require additional assistance with this, please contact Susan Lujan or I and we will be happy to help. I'd like to also remind every board to ensure that they are sending agendas and minutes to BOTH me and Susan Lujan ([slujan@whitepinecountynv.gov](mailto:slujan@whitepinecountynv.gov)) to ensure it gets posted in time in case one of us is not in the office.

Feel free to contact my office if you need assistance of any kind. Thank you for another great year! It is always a pleasure working with you, the great volunteers that make White Pine County so great. I look forward to what 2020 has to offer! Have a blessed year!

Respectfully,

Nichole Baldwin  
County Clerk  
Ex-Officio Clerk to the Board of Commissioners

